

Complying standards:
IEC 61056-1/2-2002
JIS C8702-1/2-2009

AGM TECHNOLOGY
ABT Enduro EHP Series



EHP6-150

6V 150Ah(10hr)

High Performance

The ABT Enduro EHP range of VRLA lead acid batteries have been designed specifically for use in applications which demand the highest levels of security and reliability. With proven compliance to the most rigorous international standards.

Enduro EHP is recognized as premium battery for Telecom/IT, Power Utilities applications. Enduro's reputation for long service life combined with excellent high rate performance also makes it the number one choice for high integrity, high specification UPS systems.

Mechanical Characteristics

	SI Unit	English Unit
Length	278mm	10.94inch
Width	178mm	7.01inch
Height	258mm	10.16inch
Total Height	258mm	10.16inch
Approx. Weight	29.0Kg	63.95lbs
Type of material for box and lids : ABS Standard (FV0 Optional)		

Product Characteristics

- Thick Pb-Ca-Sn alloy grids designed to resist corrosion and prolong life
- Low resistance microporous glass fibre separator
- Low specific acid density
- High integrity pillar seal
- Maintenance-Free Operation
- Low Pressure Venting System
- Low Self Discharge
- U. L. Components Recognition
- Six months shelf life at 20°C
- Design life 12+ years

Performance Characteristics

Nominal Voltage	6V
Number of Cell	3
Nominal Capacity 20°C (68°F)	10 hour rate (15.0A, 5.4V) 150.00Ah 8 hour rate (18.47A, 5.25V) 147.76Ah 1 hour rate (97.7A, 5.25V) 97.70Ah
Intensity	
Max. Discharge Current	20°C (68°F) 1200A(5s)
Short circuit current	2430A
Maximum charge current	30A(20% of rated capacity)
Internal Resistance	Fully Charged battery 20°C (68°F) 2.47mOhms
Mass Energy(Wh/kg)	31.03
Volumic Energy(Wh/L)	76.42
Self-Discharge	3% of capacity declined per month at 20°C(average)
Operating Temperature Range	Discharge -20~60°C Charge -10~60°C Storage -20~60°C
Charge Methods:	Constant Voltage Charge 20°C (68°F) Cycle use 7.02-7.14V Temperature compensation -12mV/°C/unit Standby use 6.72-6.84V Temperature compensation -10.5mV/°C/unit
Terminal Type	Inserted Thread and bolt M8X φ 18
Torque strength in Nm	12~16
Handle Type	Incorporated
Flame arrester	Yes

Dimensions / Terminal

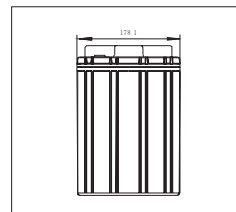
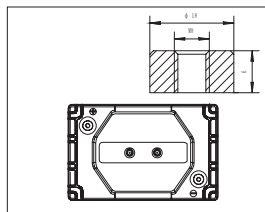
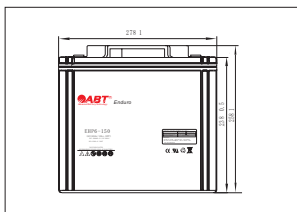

Constant Current Discharge Data (Amperes at 20°C/68°F)

End Volt. Per Cell	5min	10min	15min	20min	25min	30min	35min	40min	45min	50min	55min	1h	1.5h	2h	2.5h	3h	4h	5h	6h	7h	8h	9h	10h	12h	24h
1.60V	452.0	356.8	294.0	241.5	203.4	178.0	158.5	142.9	129.8	118.4	108.8	100.0	74.5	59.3	48.9	40.4	32.9	26.9	23.65	21.10	19.14	17.14	15.50	13.15	6.75
1.65V	418.6	337.2	279.1	229.5	196.0	172.5	154.8	140.5	128.1	117.2	108.0	99.5	73.0	58.4	48.2	39.8	32.4	26.6	23.24	20.84	18.90	16.96	15.40	13.04	6.66
1.70V	386.7	313.2	261.0	218.2	188.3	167.6	150.9	137.9	125.9	115.7	107.0	98.6	71.6	57.6	47.4	39.2	31.8	26.1	22.95	20.65	18.70	16.74	15.30	12.97	6.56
1.75V	355.5	287.2	243.7	207.6	180.4	161.6	146.8	134.8	123.9	113.9	105.7	97.7	70.3	56.4	46.6	38.7	31.3	25.6	22.58	20.40	18.47	16.55	15.20	12.86	6.47
1.80V	312.0	265.7	224.5	196.5	172.4	156.1	142.8	131.9	122.0	112.3	104.2	96.7	68.7	55.5	45.9	38.1	30.7	25.2	22.32	20.14	18.22	16.41	15.00	12.75	6.45

Constant Power Discharge Data (Watts per cell at 20°C/68°F)

End Volt. Per Cell	5min	10min	15min	20min	25min	30min	35min	40min	45min	50min	55min	1h	1.5h	2h	2.5h	3h	4h	5h	6h	7h	8h	9h	10h	12h	24h
1.60V	736.0	593.0	488.4	418.1	361.5	315.9	279.5	251.7	228.8	210.9	199.6	191.8	140.2	110.8	92.3	77.3	63.6	52.8	45.50	39.78	35.82	32.36	29.44	24.87	13.15
1.65V	699.2	568.7	469.9	402.1	351.7	309.2	273.8	247.9	226.3	209.3	198.4	190.7	138.7	109.8	91.3	76.7	63.1	52.5	45.30	39.57	35.63	32.25	29.33	24.82	13.08
1.70V	658.0	541.2	450.4	388.8	342.2	302.2	268.1	244.2	223.5	207.5	197.2	189.7	136.8	108.8	90.2	76.1	62.7	52.1	45.00	39.33	35.47	32.16	29.26	24.76	12.99
1.75V	620.4	506.3	427.3	374.0	332.4	293.9	262.5	240.0	220.3	205.4	195.7	188.6	134.7	107.4	89.2	75.5	62.1	51.7	44.70	39.08	35.33	32.05	29.20	24.69	12.92
1.80V	574.0	472.8	404.6	361.9	320.6	284.9	255.9	235.8	217.0	203.4	194.1	187.3	132.3	106.0	88.3	75.0	61.6	51.3	44.33	38.79	35.10	31.90	29.11	24.62	12.84

Constant Current Discharge Curve

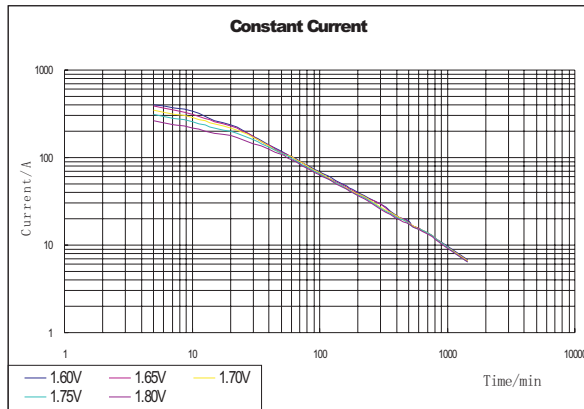

Capacity Vs Temperature

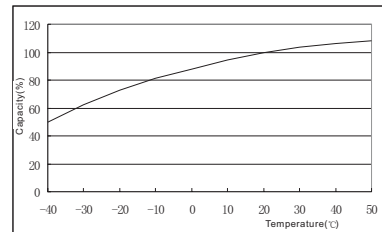

Self Discharge

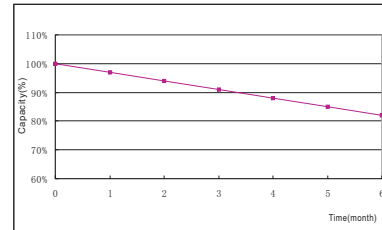

Constant Power Discharge Curve

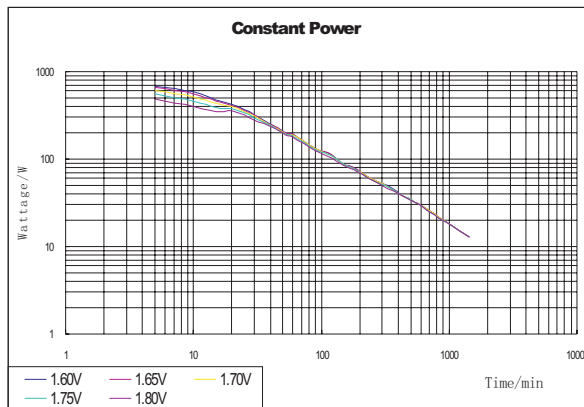

Floating Charge Voltage Vs Temperature

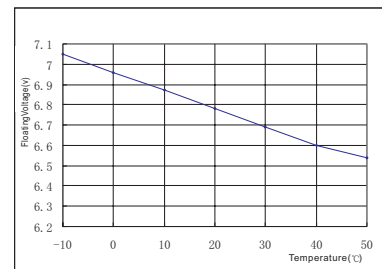

Contact information

Shandong Sacred Sun Power Sources Co., Ltd.
 Add: 1, Shengyang Road, Qufu 273100 Shandong, China
 Tel: +86-537-4438 666 extn 6028 Fax: +86-537-4411 936
 Website: <http://www.abtbatt.com> E-mail: sales@abtbatt.com

ABT VRLA Battery: Available Power Range From 7Ah to 3000Ah

Copyright SACREDSUN,
 All rights reserved.
 (Edition: May, 2011)